

QUEEN ST E & LESLIE ST

Toronto, Ontario

LOCATION

1285 Queen St E, Toronto, ON

TOTAL GLA

7,330 sq. ft.

SITE FEATURES

The Poet is a boutique residential condominium in Leslieville. 94 walkability score with access to the 24-hour Queen St. streetcar. Highly-visible retail fronting Queen St. E.

DEMOGRAPHICS

POPULATION

151,540 (3 km)
458,146 (5 km)

AVERAGE HOUSEHOLD INCOME

\$151,323 (3 km)
\$145,422 (5km)

EMPLOYMENT

63,861 (3 km)
491,070 (5 km)

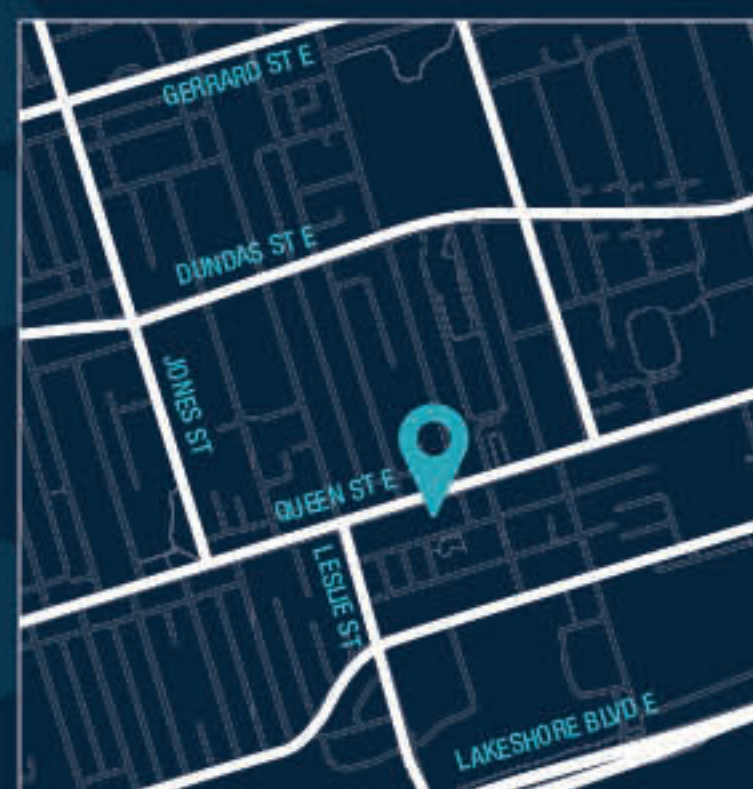



← TO LESLIE STREET

QUEEN STREET EAST

**QUEEN ST E &
LESLIE ST**
Toronto, Ontario

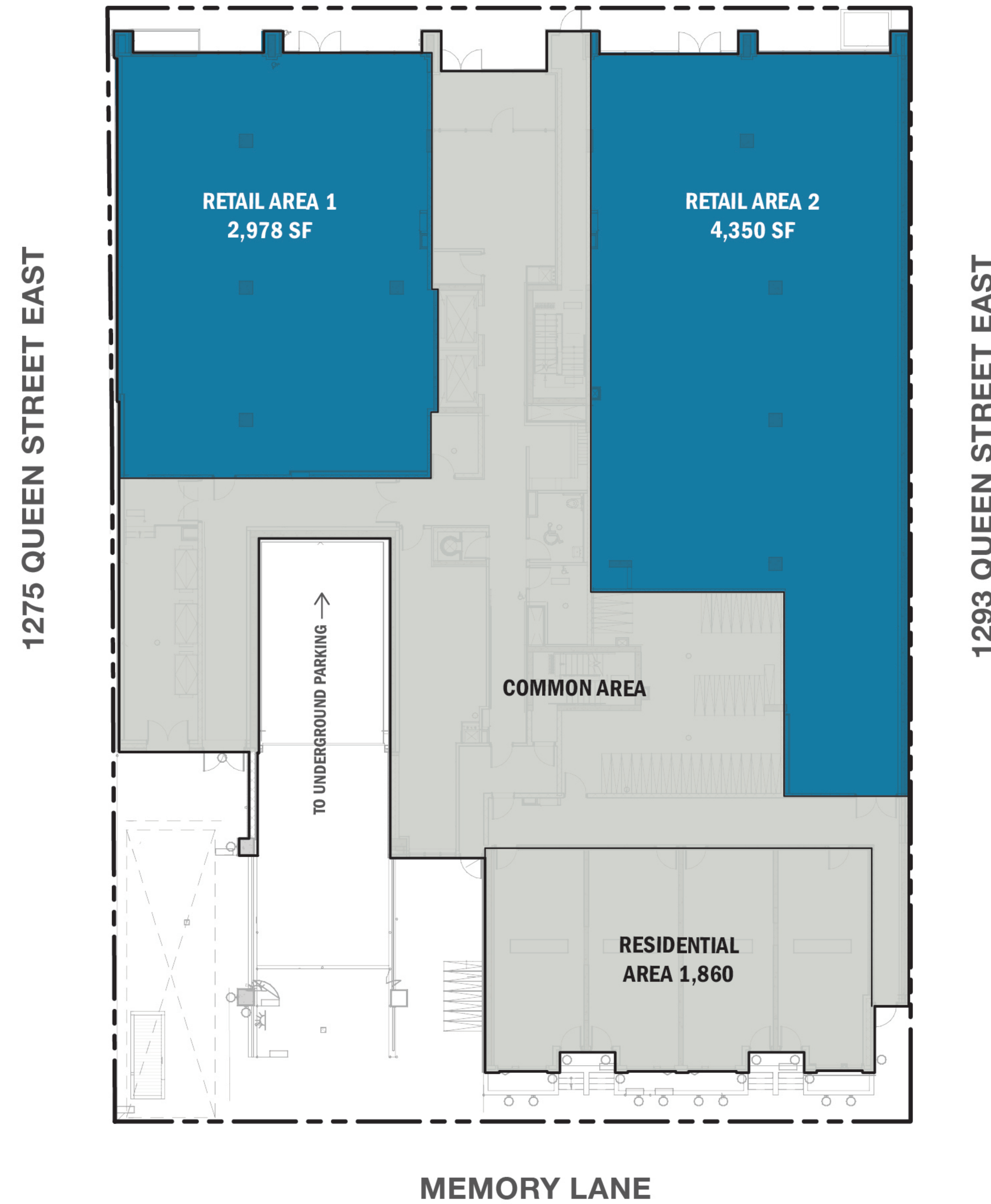

LEASED SPACE AVAILABLE SPACE