

HWY 10/89 & DUFFERIN RD 124
SHELburne, ONTARIO



HWY 10/89 & DUFFERIN RD 124

SHELBURNE, ONTARIO

LOCATION

Hwy 10/89 &
Dufferin Rd 124
Shelburne, Ontario

TOTAL GLA

100,000 sq. ft.

SITE FEATURES

- Strategically located along Highway 89 to service the growing trade area
- Identified as a primary growth area in Dufferin County.

DEMOGRAPHICS

Population

7,644 (3 km)

8,332 (5 km)

Average Household Income

\$96,514 (3 km)

\$97,088 (5 km)

Employment

2,589 (3 km)

2,668 (5 km)

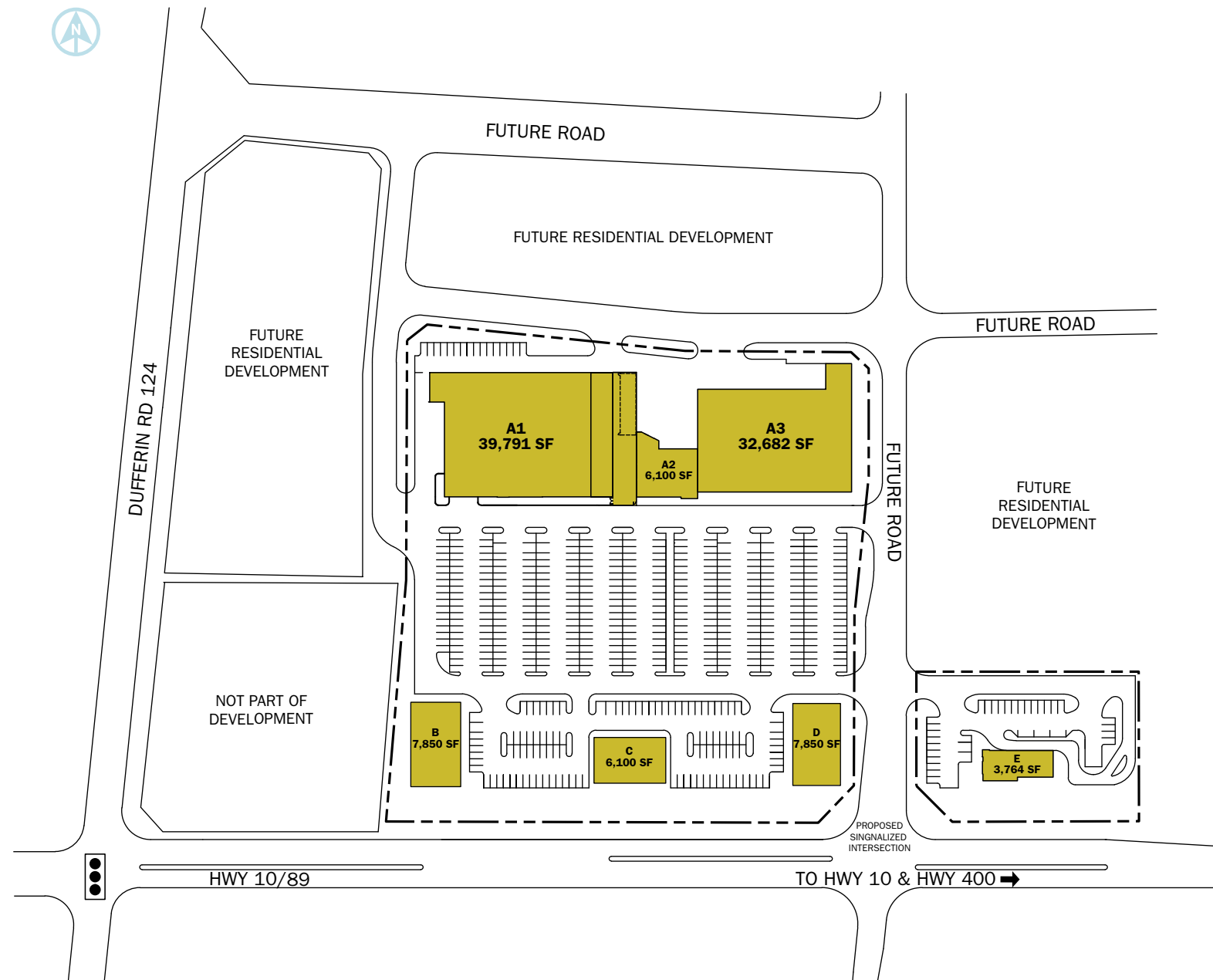
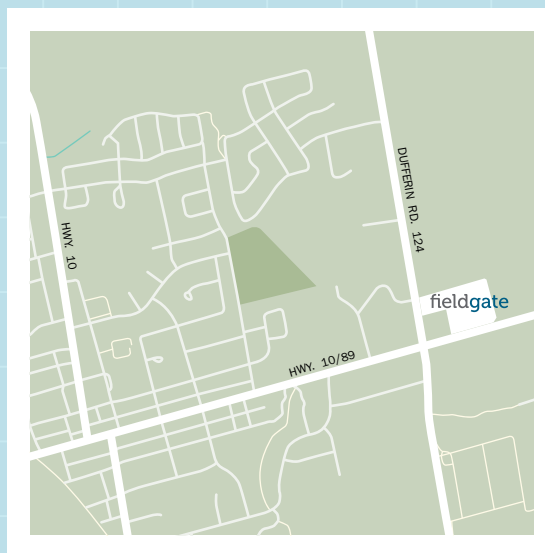

■ AVAILABLE SPACE
■ LEASED SPACE