

WESTWOOD SQUARE  
MISSISSAUGA, ONTARIO



# WESTWOOD SQUARE

MISSISSAUGA, ONTARIO



## LOCATION

Goreway Dr & Derry Rd E  
Mississauga, Ontario

## TOTAL GLA

425,000 sq. ft.

## SITE FEATURES

- Services established trade area of 40,000
- Contains established mix of service commercial and retail in urban setting
- Lands available for expansion and revitalization

## TENANTS

Walmart  
FreshCo.  
Shoppers Drug Mart  
Beer Store  
CIBC  
Dollarama  
Fit4Less by GoodLife  
LCBO  
Popeye's  
RBC  
Scotiabank  
TD Canada Trust  
Tim Horton's

## DEMOGRAPHICS

**Population**  
57,580 (3 km)  
97,154 (5 km)

**Average Household Income**  
\$88,244 (3 km)  
\$86,735 (5 km)

**Employment**  
110,603 (3 km)  
171,688 (5 km)

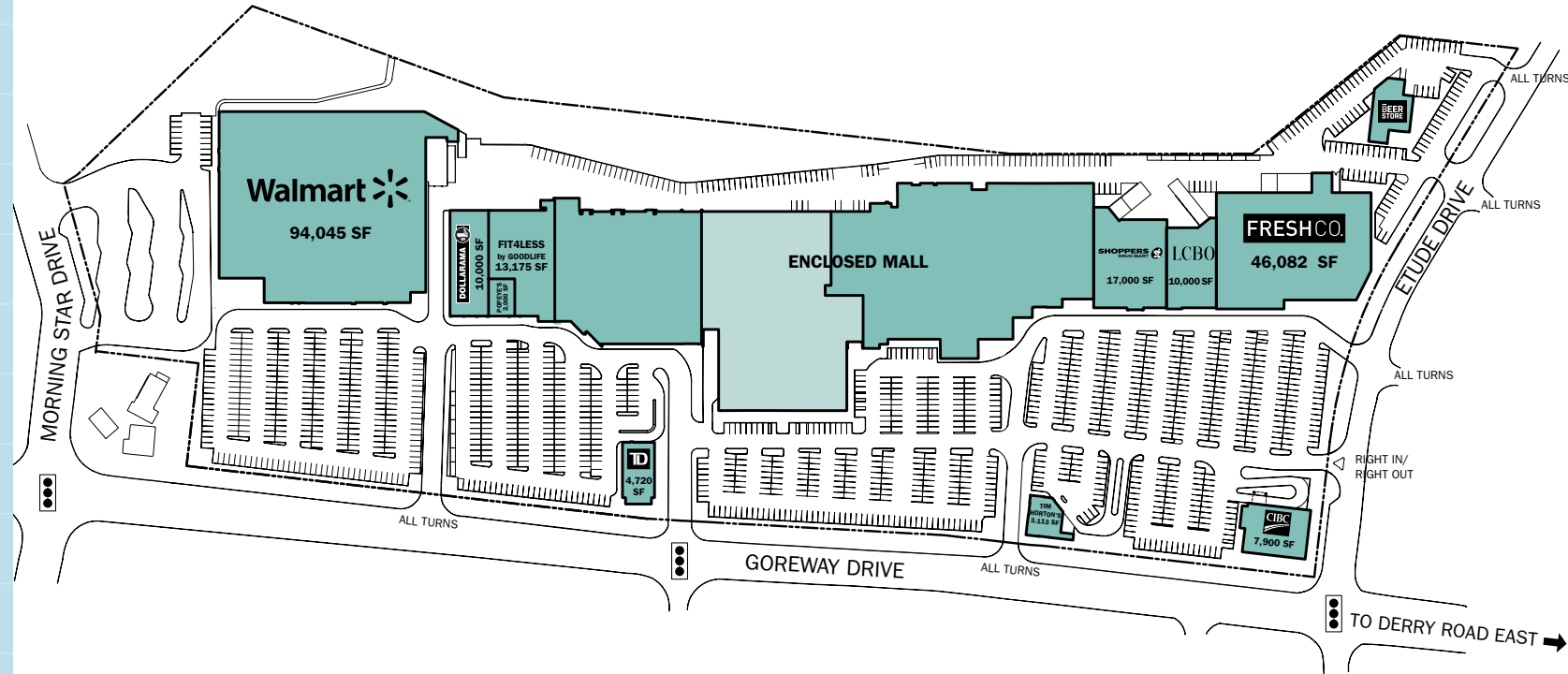
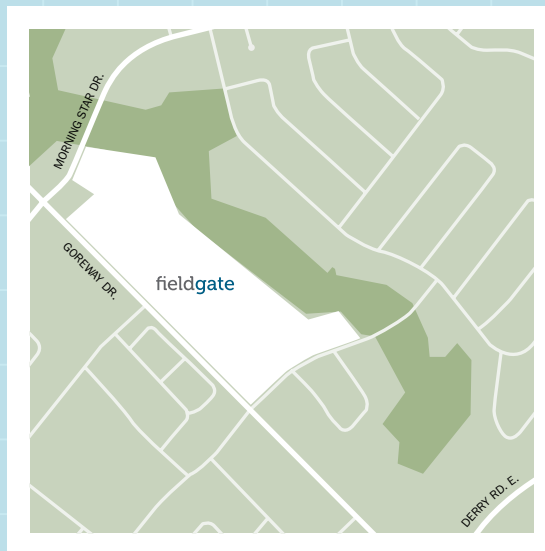

■ AVAILABLE SPACE  
■ LEASED SPACE